

| GATE, GLOBE & CHECK VALVES |

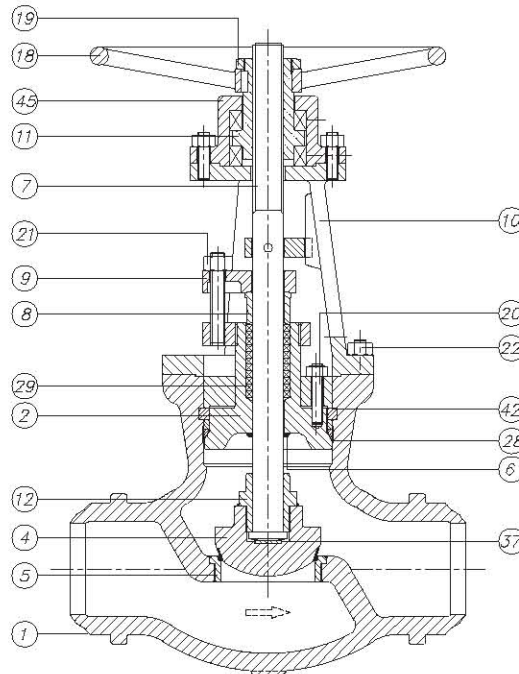

GLOBE VALVES PRESSURE SEAL

2" - 16" | Class 900 - Class 2500



BILL OF MATERIALS		TRIM 8	TRIM 2	TRIM 8	TRIM 10
Item	Description	Carbon Steel	Carbon Steel (Low Temp.)	Alloy Steel	Stainless Steel
1	Body	A 216 Gr. WCB	A 352 Gr. LCB	A 217 Gr. C5	A 351 Gr. CF8M
2	Bonnet	A 216 Gr. WCB	A 352 Gr. LCB	A 217 Gr. C5	A 351 Gr. CF8M
4	Disc	A105 + Stellite	A182 Gr. F304 + Stellite	A 217 Gr. C5 + Stellite	A182 Gr. F316 + Stellite
5	Seat Ring	A105 + Stellite	A182 Gr. F304 + Stellite	A182 Gr. F6a + Stellite	A182F316 + Stellite
6	Backseat	Stellite	Stellite	Stellite	Stellite
7	Stem	A182 Gr. F6a	A182 Gr. F304	A182 Gr. F6a	A 182 Gr. F316
8	Gland	A105	A105	A182 Gr. F6a	A 182 Gr. F316
9	Gland Flange	A 105	A 105	A 105	A 182 Gr. F304
10	Yoke	A 216 Gr. WCB	A 352 Gr. LCB	A 217 Gr. C5	A 351 Gr. CF8M
11	Stem Nut	B148 / A 439 Gr. D2	B148 / A 439 Gr. D2	B148 / A 439 Gr. D2	B148 / A 439 Gr. D2
12	Disc Nut	A182 Gr. F6a	A182 Gr. F304	A182 Gr. F6a	A182 Gr. F316
18	Handwheel	Carbon Steel	Carbon Steel	Carbon Steel	Carbon Steel
19	Handwheel Nut	Steel	Steel	Steel	Steel
20	Bonnet Bolt & Nut	A 193 Gr. B7 / A 194 Gr. 2H	A320 Gr. L7 / A194 Gr. 7	A 193 Gr. B7 / A 194 Gr. 2H	A 193 Gr. B7 / A 194 Gr. 2H ⁽¹⁾
21	Bolt & Nut	A 193 Gr. B7 / A 194 Gr. 2H	A 193 Gr. B7 / A 194 Gr. 2H	A 193 Gr. B7 / A 194 Gr. 2H	A 193 Gr. B7 / A 194 Gr. 2H
22	Yoke Bolt & Nut	A 193 Gr. B7 / A 194 Gr. 2H	A 193 Gr. B7 / A 194 Gr. 2H	A 193 Gr. B7 / A 194 Gr. 2H	A 193 Gr. B7 / A 194 Gr. 2H ⁽¹⁾
28	Gasket (Class 900)	Graphite or SS304L	Graphite or SS304L	Graphite or SS304L	Graphite or SS316L
28	Gasket (Class 1500)	Graphite or SS304L	Graphite or SS304L	Graphite or SS304L	Graphite or SS316L
28	Gasket (Class 2500)	Graphite or SS304L	Graphite or SS304L	Graphite or SS304L	Graphite or SS316L
29	Stem Packing	Graphite	Graphite	Graphite	Graphite
37	Thrust Washer	A182 Gr. F6a	A182 Gr. F304	A182 Gr. F6a	A182 Gr. F316
42	Segmental Ring	A 105	A182 Gr. F304	A182 Gr. F6a	A182 Gr. F316
45	Lock Nut	Steel	A182 Gr. F304	A182 Gr. F6a	A182 Gr. F316

Sizes 2" to 16"

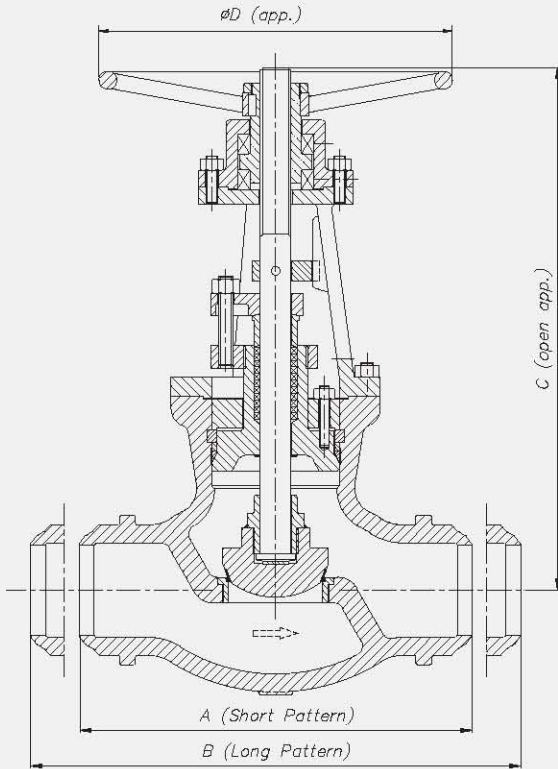

* Long pattern available with flanges.

TRIM

API 600 TRIM N°	Nominal TRIM	Stem / Backseat	Seating Surface Body / Wedge
1	F6	13Cr	13Cr
2	304	18Cr-8Ni	18Cr-8Ni
3	F310	25Cr-20Ni	25Cr-20Ni
4	Hard F6	13Cr	Hard 13Cr
5	Hardfaced	13Cr	Co-Cr A
5A	Hardfaced	13Cr	Ni-Cr
6	F6 and Cu-Ni	13Cr	13Cr and Cu-Ni
7	F6 and Hard F6	13Cr	13Cr and Hard 13Cr
8	F6 and Hardfaced	13Cr	13Cr and Co-Cr A
8A	F6 and Hardfaced	13Cr	13Cr and Ni-Cr
9	Monel	Ni-Cu Alloy	Ni-Cu Alloy
10	316	18Cr-8Ni-Mo	18Cr-8Ni-Mo
11	Monel and Hardfaced	Ni-Cu Alloy	Ni-Cu Alloy and Trim 5 or 5A
12	316 and Hardfaced	18Cr-8Ni-Mo	18Cr-8Ni-Mo and Trim 5 or 5A
13	Alloy 20	19Cr-29Ni	19Cr-29Ni
14	Alloy 20 and Hardfaced	19Cr-29Ni	19Cr-29Ni and Trim 5 or 5A
15	Hardfaced	18Cr-8Ni	Co-CrR A
16	Hardfaced	18Cr-8Ni-Mo	Co-CrR A
17	Hardfaced	18Cr-10Ni-Cb	Co-CrR A
18	Hardfaced	19Cr-29Ni	Co-CrR A

HF: Hard Facing using CoCr welding alloy (Stellite)

Materials

ACC. / ASME B16.34
DI, WCB, WCC, WC1, WC6, WC9, C5, C12, LCB, LCC, GF8, GF8C, CF8M, CF3, CF3M,
DUPLEX, SUPERDUPLEX, EXOTIC MATERIALS.

General dimensions

DN	A	B	C	ØD	WEIGHT (App.) (**)
50 (2")	216	368	460	350	90
65 (2½")	254	419	535	350	105
80 (3")	305	381	605	400	120
100 (4")	356	457	750	450	195
125 (5")	432	559	815	450	230
150 (6")	508	610	875	500 (*)	355 (*)
200 (8")	660	737	930	500 (*)	630 (*)
250 (10")	787	838	1095	640 (*)	885 (*)
300 (12")	914	965	1205	640 (*)	1135 (*)
350 (14")	991	1029	1310	710 (*)	1580 (*)
400 (16")	1092	1130	1425	710 (*)	2295 (*)

(*) With Gear Operator

(**) BW ends, short pattern.

Dimensions in mm and weight in kg.

Weights and dimensions can be changed without notice.

Bigger sizes available under customer request.

ASME B16.34 PRESSURE SEAL

Class 1500

VG1500PS

Sizes 2" to 16"

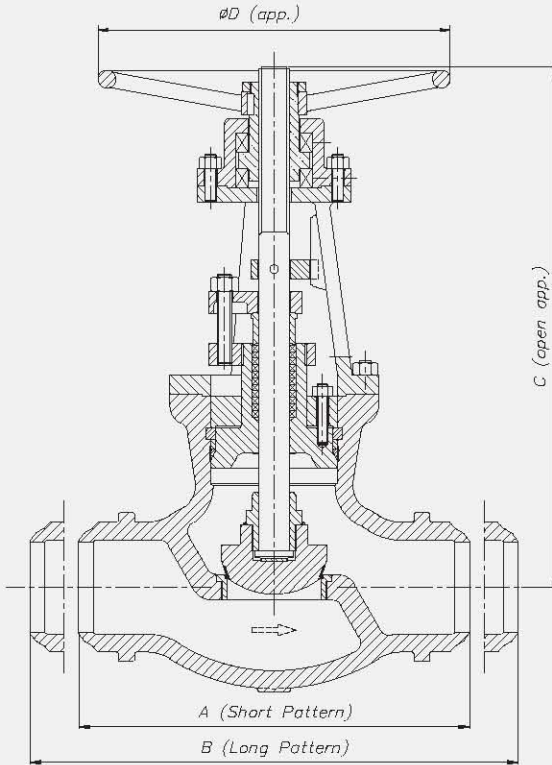

* Long pattern available with flanges.

TRIM

API 600 TRIM N°	Nominal TRIM	Stem / Backseat	Seating Surface Body / Wedge
1	F6	13Cr	13Cr
2	304	18Cr-8Ni	18Cr-8Ni
3	F310	25Cr-20Ni	25Cr-20Ni
4	Hard F6	13Cr	Hard 13Cr
5	Hardfaced	13Cr	Co-Cr A
5A	Hardfaced	13Cr	Ni-Cr
6	F6 and Cu-Ni	13Cr	13Cr and Cu-Ni
7	F6 and Hard F6	13Cr	13Cr and Hard 13Cr
8	F6 and Hardfaced	13Cr	13Cr and Co-Cr A
8A	F6 and Hardfaced	13Cr	13Cr and Ni-Cr
9	Monel	Ni-Cu Alloy	Ni-Cu Alloy
10	316	18Cr-8Ni-Mo	18Cr-8Ni-Mo
11	Monel and Hardfaced	Ni-Cu Alloy	Ni-Cu Alloy and Trim 5 or 5A
12	316 and Hardfaced	18Cr-8Ni-Mo	18Cr-8Ni-Mo and Trim 5 or 5A
13	Alloy 20	19Cr-29Ni	19Cr-29Ni
14	Alloy 20 and Hardfaced	19Cr-29Ni	19Cr-29Ni and Trim 5 or 5A
15	Hardfaced	18Cr-8Ni	Co-CrR A
16	Hardfaced	18Cr-8Ni-Mo	Co-CrR A
17	Hardfaced	18Cr-10Ni-Cb	Co-CrR A
18	Hardfaced	19Cr-29Ni	Co-CrR A

HF: Hard Facing using CoCr welding alloy (Stellite)

Materials

ACC. / ASME B16.34
 DI, WCB, WCC, WC1, WC6, WC9, C5, C12, LCB, LCC, CF8, CF8C, CF8M, CF3, CF3M,
 DUPLEX, SUPERDUPLEX, EXOTIC MATERIALS.

General dimensions

DN	A	B	C	ØD	WEIGHT (App.) (**)
50 (2")	216	368	592	350	82
65 (2½")	254	419	660	400	135
80 (3")	305	470	692	450	192
100 (4")	406	546	907	500 (*)	307 (*)
125 (5")	483	673	960	500 (*)	485 (*)
150 (6")	559	705	1015	640 (*)	659 (*)
200 (8")	711	832	1150	640 (*)	945 (*)
250 (10")	864	991	1350	710 (*)	1080 (*)
300 (12")	991	1130	1740	710 (*)	1505 (*)
350 (14")	1067	1257	2095	760 (*)	2240 (*)
400 (16")	1194	1384	2490	760 (*)	3450 (*)

(*) With Gear Operator.
 (**) BW ends, short pattern.
 Dimensions in mm and weight in kg.
 Weights and dimensions can be changed without notice.
 Bigger sizes available under customer request.

Sizes 2" to 12"

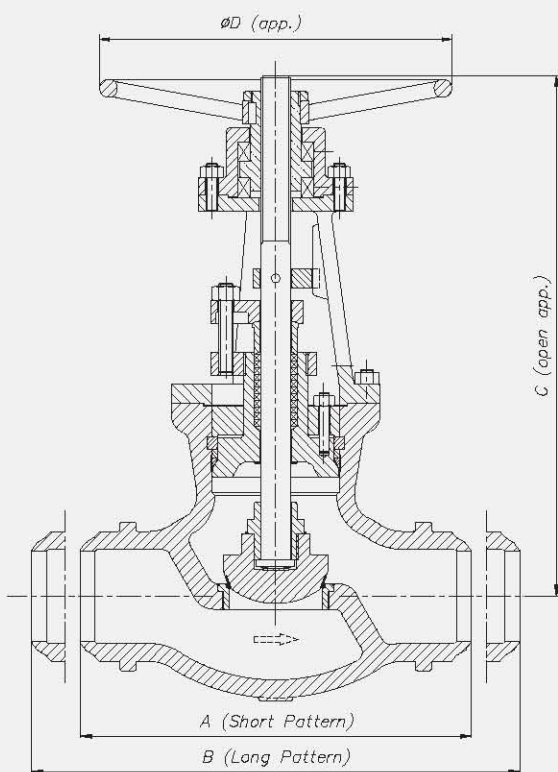

* Long pattern available with flanges.

TRIM

API 600 TRIM N°	Nominal TRIM	Stem / Backseat	Seating Surface Body / Wedge
1	F6	13Cr	13Cr
2	304	18Cr-8Ni	18Cr-8Ni
3	F310	25Cr-20Ni	25Cr-20Ni
4	Hard F6	13Cr	Hard 13Cr
5	Hardfaced	13Cr	Co-Cr A
5A	Hardfaced	13Cr	Ni-Cr
6	F6 and Cu-Ni	13Cr	13Cr and Cu-Ni
7	F6 and Hard F6	13Cr	13Cr and Hard 13Cr
8	F6 and Hardfaced	13Cr	13Cr and Co-Cr A
8A	F6 and Hardfaced	13Cr	13Cr and Ni-Cr
9	Monel	Ni-Cu Alloy	Ni-Cu Alloy
10	316	18Cr-8Ni-Mo	18Cr-8Ni-Mo
11	Monel and Hardfaced	Ni-Cu Alloy	Ni-Cu Alloy and Trim 5 or 5A
12	316 and Hardfaced	18Cr-8Ni-Mo	18Cr-8Ni-Mo and Trim 5 or 5A
13	Alloy 20	19Cr-29Ni	19Cr-29Ni
14	Alloy 20 and Hardfaced	19Cr-29Ni	19Cr-29Ni and Trim 5 or 5A
15	Hardfaced	18Cr-8Ni	Co-CrR A
16	Hardfaced	18Cr-8Ni-Mo	Co-CrR A
17	Hardfaced	18Cr-10Ni-Cb	Co-CrR A
18	Hardfaced	19Cr-29Ni	Co-CrR A

HF: Hard Facing using CoCr welding alloy (Stellite)

Materials

ACC. / ASME B16.34
DI, WCB, WCC, WC1, WC6, WC9, C5, C12, LCB, LCC, GF8, GF8C, CF8M, CF3, CF3M,
DUPLEX, SUPERDUPLEX, EXOTIC MATERIALS.

General dimensions

DN	A	B	C	ØD	WEIGHT (App.) ^(*)
50 (2")	279	451	620	350	95
65 (2½")	330	508	705	400	175
80 (3")	368	578	750	450	265
100 (4")	457	673	980	500 ^(*)	385 ^(*)
125 (5")	533	794	1060	500 ^(*)	480 ^(*)
150 (6")	610	914	1130	640 ^(*)	685 ^(*)
200 (8")	762	1022	1285	710 ^(*)	870 ^(*)
250 (10")	914	1270	1490	710 ^(*)	1450 ^(*)
300 (12")	1041	1422	1680	760 ^(*)	2105 ^(*)

^(*) With Gear Operator.

^(**) BW ends, short pattern.

Dimensions in mm and weight in kg.

Weights and dimensions can be changed without notice.

Bigger sizes available under customer request.