

HF

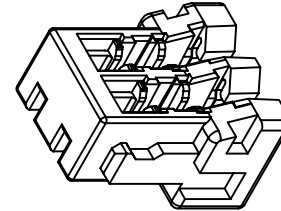
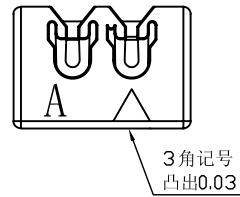
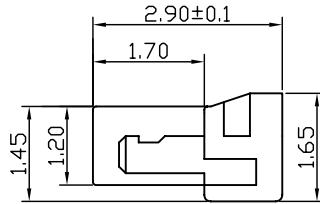
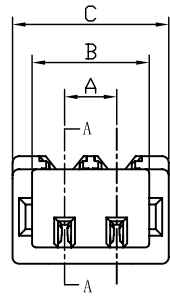

Specifications:

- Voltage rating: 30V AC / DC
- Current rating: 0.5A AC/DC
- Withstanding voltage: 200V AC/minute
- Temperature range: -25° C ~ +85° C
- Insulation resistance: ≥100MΩ
- Contact resistance: ≤20mΩ
- After environmental testing: ≤30mΩ
- Wire range: 32AWG(7/0.08mm) OD:0.38mm
- Plastic material: PA66 UL 94V-0
- Terminal material: Phosphor bronze
- Finish: Gold-Plated

0800 W XX 7 1 1 00

① ② ③ ④ ⑤ ⑥ ⑦

- ①Series:
- ②Category: W-Wire B-Board
- ③Circuit number: XX PIN
- ④Plastic material and color:
7-Natural PA66
- ⑤Terminal material & finish:
1-Gold-plated Phosphor bronze
- ⑥Finish specification: 1-1U"
- ⑦Special code:

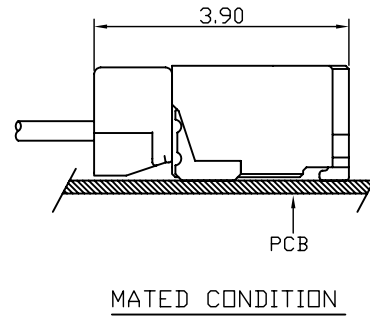
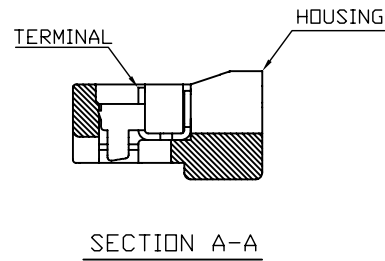
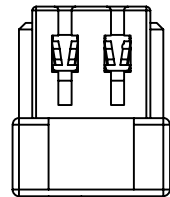

Poles	Dimensions			Poles	Dimensions		
	A	B	C		A	B	C
02	0.80	1.80	2.40	10	7.20	8.20	8.80
03	1.60	2.60	3.20	11	8.00	9.00	9.60
04	2.40	3.40	4.00	12	8.80	9.80	10.40
05	3.20	4.20	4.80	13	9.60	10.60	11.20
06	4.00	5.00	5.60	14	10.40	11.40	12.00
07	4.80	5.80	6.40	15	11.20	12.20	12.80
08	5.60	6.60	7.20	16	12.00	13.00	13.60
09	6.40	7.40	8.00				

2016/02/25		B	Change to the new version	ZLY	GENERAL TOLERANCE				Part NO: 0800WXX71100								
2015/05/20		A			.X ±0.3				TITLE:								
					.XX ±0.2				XXP 0.8mm WTB IDC/A type natural								
					.XXX ±0.1				APPROVED								
DATA	EDITION	DESCRIPTION		DRAW	PROJECT				UNIT	SCALE	PAGE	EDITION	CHECK	DRAW	DATA	FILE NUMBER	
									MM	1:1	1 OF 1	B	Eis	KHM	ZLY	2016/02/25	LSTC-C0-004

ROHS

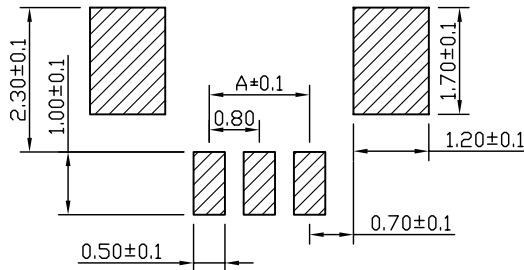
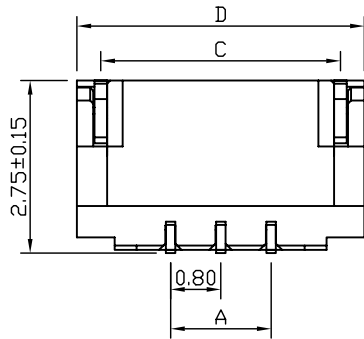
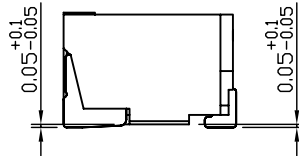
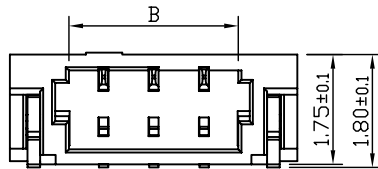
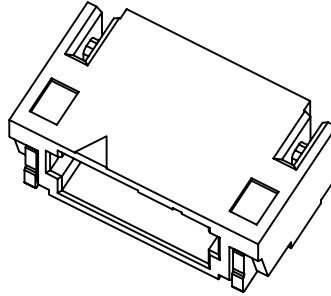
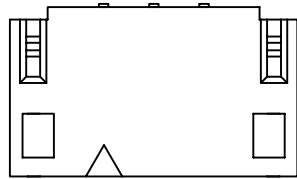

PCB LAYOUT

■ Specifications:

- Voltage rating: 30V AC/DC
- Current rating: 0.5A AC/DC
- Withstanding voltage: 200V AC/minute
- Temperature range: -25° C ~ +85° C
- Insulation resistance: ≥100MΩ
- Contact resistance: ≤20mΩ
- After environmental testing: ≤30mΩ
- Plastic material: LCP UL 94V-0
- Terminal material: Phosphor bronze
- Finish: Gold-Plated

0800 B XX 8 1 1 00

- ①Series:
- ②Category: W-Wire B-Board
- ③Circuit number: XX PIN
- ④Plastic material and color:
8-Natural LCP
- ⑤Terminal material & finish:
1-Gold-plated Phosphor bronze
- ⑥Finish specification: 1-IU"
- ⑦Special code:
00-Horizontal 01-Vertical

Poles	Dimensions				Poles	Dimensions			
	A	B	C	D		A	B	C	D
02	0.80	1.90	3.04	3.78	10	7.20	8.30	9.44	10.18
03	1.60	2.70	3.84	4.58	11	8.00	9.10	10.24	10.98
04	2.40	3.50	4.64	5.38	12	8.80	9.90	11.04	11.78
05	3.20	4.30	5.44	6.18	13	9.60	10.70	11.84	12.58
06	4.00	5.10	6.24	6.98	14	10.40	11.50	12.64	13.38
07	4.80	5.90	7.04	7.78	15	11.20	12.30	13.44	14.18
08	5.60	6.70	7.84	8.58	16	12.00	13.10	14.24	14.98
09	6.40	7.50	8.64	9.38					

				GENERAL TOLERANCE	Part NO:								
2016/02/25		B	Change to the new version	ZLY	.X ±0.3				0800BXX81100				
2015/05/20		A			.XX ±0.2				TITLE:				
DATA		EDITION	DESCRIPTION	DRAW	.XXX ±0.1				XXP 0.8mm WTB SMT/A Type Natural				
				PROJECT	UNIT	SCALE	PAGE	EDITION	APPROVED	CHECK	DRAW	DATA	FILE NUMBER
					MM	1:1	1 OF 1	B	Eis	KHM	ZLY	2016/02/25	LSTC-C0-003

ROHS

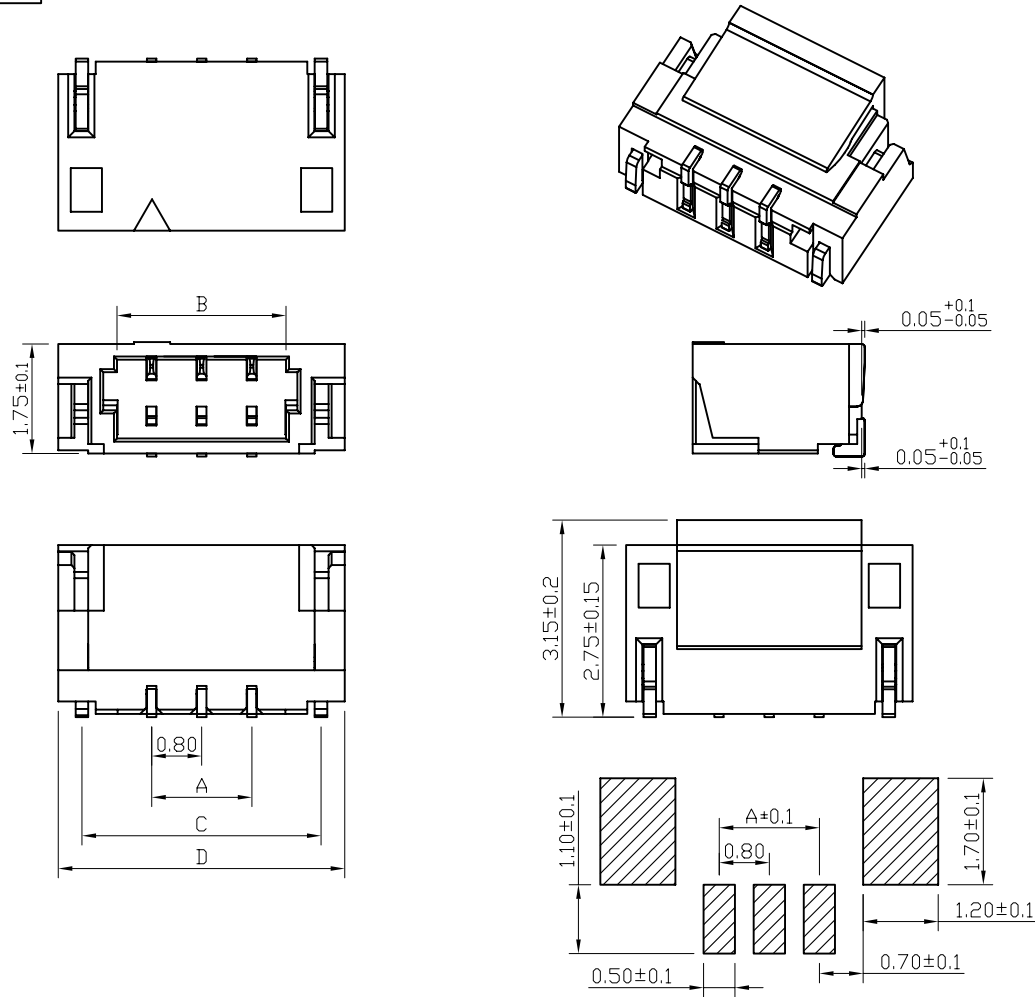

Specifications:

- Voltage rating: 30V AC/DC
- Current rating: 0.5A AC/DC
- Withstanding voltage: 200V AC/minute
- Temperature range: -25° C ~ +85° C
- Insulation resistance: ≥100MΩ
- Contact resistance: ≤20mΩ
- After environmental testing: ≤30mΩ
- Plastic material: LCP UL 94V-0
- Terminal material: Phosphor bronze
- Finish: Gold-Plated

0800 B XX 8 1 1 01

- ⓪Series:
- ⓁCategory: W-Wire B-Board
- ⓁCircuit number: XX PIN
- ⓁPlastic material and color:
8-Natural LCP
- ⓁTerminal material & finish:
1-Gold-plated Phosphor bronze
- ⓁFinish specification: 1-1U"
- ⓁSpecial code:
00-Horizontal 01-Vertical

Poles	Dimensions				Poles	Dimensions			
	A	B	C	D		A	B	C	D
02	0.80	1.90	3.04	3.78	10	7.20	8.30	9.44	10.18
03	1.60	2.70	3.84	4.58	11	8.00	9.10	10.24	10.98
04	2.40	3.50	4.64	5.38	12	8.80	9.90	11.04	11.78
05	3.20	4.30	5.44	6.18	13	9.60	10.70	11.84	12.58
06	4.00	5.10	6.24	6.98	14	10.40	11.50	12.64	13.38
07	4.80	5.90	7.04	7.78	15	11.20	12.30	13.44	14.18
08	5.60	6.70	7.84	8.58	16	12.00	13.10	14.24	14.98
09	6.40	7.50	8.64	9.38					

PCB LAYOUT

A	2016/01/25	B	Change to the new version	Kuang	GENERAL TOLERANCE . X ±0.3 . XX ±0.2 . XXX ±0.1				Part NO: 0800BXX81101								
	2015/07/08	A			PROJECT				TITLE: XXP 0.8mm WTB SMT/B Type Natural Gold Plated				APPROVED	CHECK	DRAW	DATA	FILE NUMBER
	DATA	EDITION	DESCRIPTION	DRAW	UNIT MM				SCALE 1:1	PAGE 1 OF 1	EDITION B	Eis	KHM	ZLY	2016/01/25	LSTC-C0-175	
						Ⓛ											