



TONYA LIGHT

PROFESSIONAL LED SOLUTION PROVIDER
Energy Saving and Environmental Protection

Since 2007



3D ATOMIZATION FIREPLACE

LIGHTING CATALOGUE

TONYA LIGHT 2021

SHENZHEN TONYA LIGHTING TECHNOLOGY CO.,LTD

Tel: +86-755-23154966 Fax: +86-755-23154866 Web: www.tyledlight.com Email: sales@tonyalight.com
Add: B Bldg, Jinlaiwang Baihua Industrial Park, Guan Guang RD, Guangming New District, Shenzhen, P.R.China



O1

3D ATOMIZATION FIREPLACE



※ Different styles and different sizes of fireplaces can be customized.

+ 3D ATOMIZATION FIREPLACE 3D 雾化壁炉

The emergence of fireplaces originated from Western countries. In addition to the decorative effect and practical value, it is also a symbol of European and American countries' identity and taste. This is especially true when you come to China, which represents romance and taste as well as a superior aesthetic vision. Whether it is a gathering of friends or a family reunion, the fireplace is a well-deserved focal point, attracting countless envious eyes. According to the culture of different countries, it is divided into: American fireplaces, British fireplaces, French fireplaces, etc.





+ 3D ATOMIZATION FIREPLACE

Tracing back to the source of fireplace, from the beginning of the Renaissance, the design and decoration of fireplace, together with the architecture of the same period, have a gradually obvious impact on today's society. These precious architectural heritages are the embodiment of the traditional value of design and handicrafts. They are not only the index of human civilization, but also make an important contribution to the quality of life we enjoy.



Variable color function ----- multi-color flame switching





+ 3D ATOMIZATION FIREPLACE

Why choice TONYA water vapour fireplace ?

A real alternative to conventional inserts and traditional fireplaces, 3D cold-flame steam fireplaces have unmatched advantages. In particular, they make it possible to overcome the main constraints of installation, operation and maintenance encountered in fireplaces that use wood or gas.

It is the subtle blend of three components, namely ultra-fine water vapor, the light from colored LEDs and the creation of different air pressures that allow real colored flames to be obtained with so much realism. Produced by a "transducer" (or mist maker), the ultrasounds are mechanical waves that will vibrate water (inaudible) turning it into ultra-fine water vapor. It should be noted that ultra-fine water vapor (only a few microns) is immediately absorbed by the ambient air. The water vapor does not condense and does not produce moisture on adjacent walls. This is often referred to as dry water vapour. This technical system produces cold flames that are so realistic that it is impossible to tell them apart from traditional flames!



What are the advantages of an Atomizing Fireplace? How does it work? what are its advantages compared to other fireplace?

1- 100% safety

First of all, we can say that the safety of the 3D water vapor fireplace is total. The flames, in fact, are cold and therefore present no danger. It is also the preferred fireplace of places receiving the public (fireplace for hotels, restaurants, businesses etc.). It is also the ideal fireplace for apartments in buildings that do not allow any hot flames in their safety regulations. But it is also the ideal fireplace for families with children that do not wish to take any risk with fire.

2- Modern fireplace without constraints

Secondly, we need to mention the simplicity of installation, operation and maintenance of a 3D insert. This steam fireplace is without constraints and consumes only tap water. This is a very important advantage when one thinks about the difficulties of supplying fossil fuels. On the other hand, it is a modern fireplace with high-tech controls: remote control, an app, buttons on the device, deported control (dry contact for home-automation applications), etc.

3- Ecological fireplace

We can really talk about an ecological fireplace in every sense of the term. Firstly, because it only uses water. And then because a 3D fireplace does not produce any harmful combustion gases. It gives off no unpleasant odours (aromatic compounds related to combustion), carbon monoxide or other polluting combustion residues. The water vapour fireplace insert also has a slightly humidifying effect that is beneficial to comfortable breathing when rooms are rendered too dry by the heating.

4- Economical fireplace

Of course, the purchase price of a water vapor fireplace remains comparable to traditional fireplaces. It is important to realize that its cost of operation is practically equal to zero. This is a huge difference and one that makes the steam fireplace the most economical appliance in terms of its annual cost. We do not hesitate to light a fire produced by tap water.

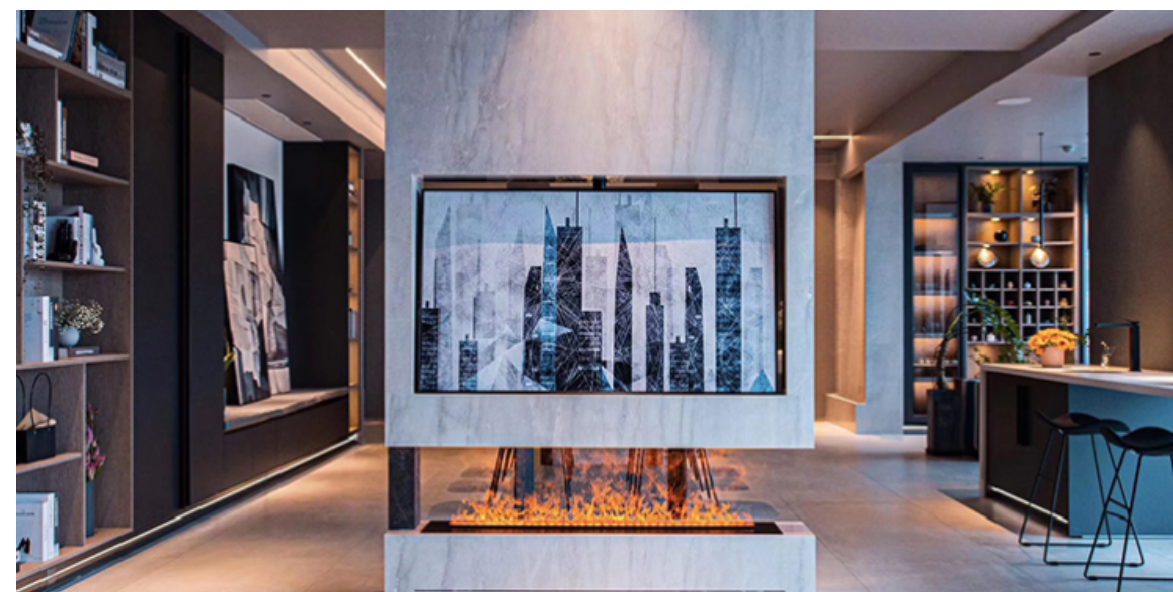

Key points for installing a 3D water vapor electric fireplace

1. It's all a question of décor: how to create a stylish fire space

How should you come up with a fire space that meets your expectations and desires? With the 3D water-vapor fireplace, the job is easy. Interior decorators, designers, and architects and professionals in fireplaces and builders are the most qualified professionals to advise you and help you install your steam fireplace insert.

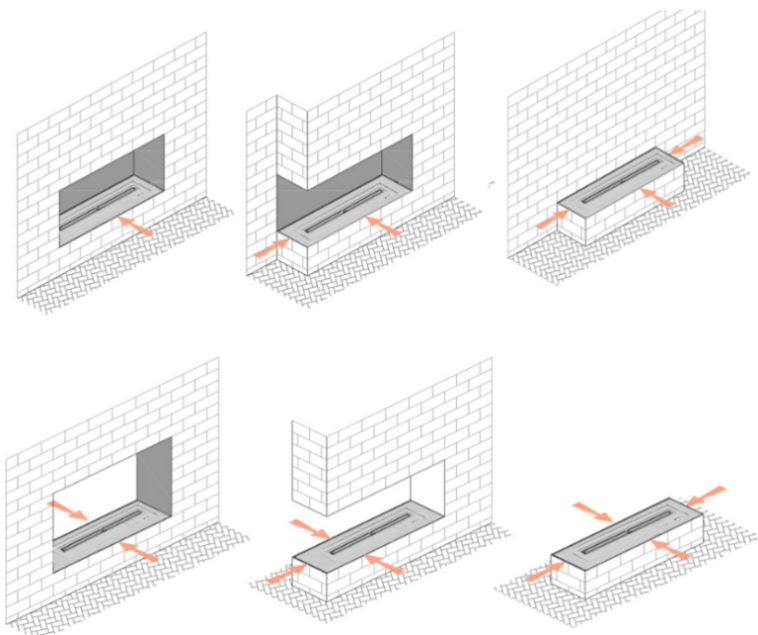

2. How to set up a water vapor insert?

A 3D fireplace runs only on water vapor and uses very little electricity. The system comes with a 100/240V (50-60 Hz) – 24V adapter. TONYA automatically provides the right electrical connector for your country.



3. How to fill the water tank?

Manual filling (a connection to the water network is not necessary).

Filling with integrated automatic pump (a connection to the water network is not necessary).

Connecting fireplace insert to the running water network



4. 3D water Vapor fireplace inserts with high-tech controls

Using high-quality LED strips, it is possible to realize a variety of color options, mainly divided into single color, three colors, seven colors, and 64 colors controlled by APP.

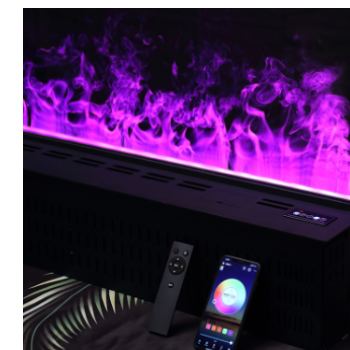
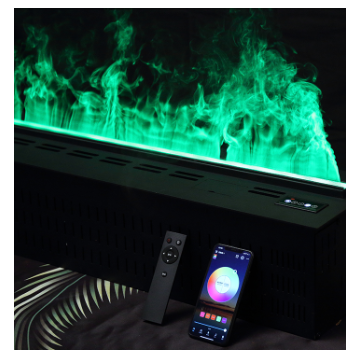
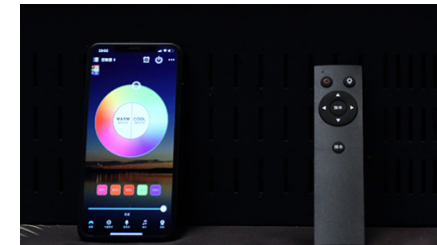

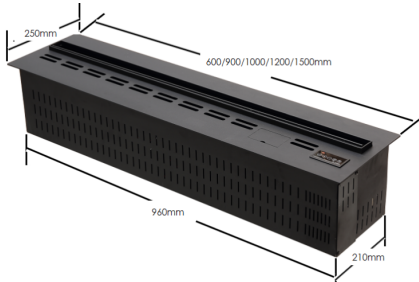

✧ Different styles and different sizes of fireplaces can be customized.

Brand:	TONYA			
Name:	3D ATOMIZATION FIREPLACE			
Application:	villas, hotels, private clubs, mansions, etc.			
Specifications:	Length 500-2400mm* Width 250mm* Height 200mm,			
	Support customization			
Panel:	Brushed stainless steel panel / black matte stainless steel panel / specific color plating panel			
Material:	Whole machine 304 stainless steel			
Usage:	Embedded			
Fuel:	pure water			
Burning time:	about 8-12 hours			
				<div><div>Operation mode:</div><div>Consumption:</div><div>Certification:</div><div>Voltage frequency:</div></div> <div><div>touch button / wireless remote control</div><div>0.6-1.1L / H</div><div>CE/ROHS/FCC</div><div>AC85-265V/50-60HZ</div></div>
Basic product configuration:	Intelligent embedded software> High-performance low-power integrated chip IC> Dual voltage protection and safety system> Automatic liquid filling system> One-key drainage system> Operation protection monitoring system> Dual anti-overflow protection system> Child lock template> Liquid level prompt module> Atomization start detection module> Tilt control module> Voice prompt (Chinese and English optional)> Remote control / button control			
Optional function:	WIFI+ APP real-time remote monitoring system (optional)			
Product accessories:	remote control, warranty card, water filling pipe (plus filter), manual, certificate, handle			
Panel accessories:	high simulation three-dimensional ceramic fiber fake wood / pebbles (optional)			
Other remarks:	A: The installation table and internal materials need moisture-proof materials.		B: The reserved installation groove needs to be hollowed out and there is a ventilation gap at the bottom.	
	C: The top and the periphery of the fireplace cannot be made of reflective materials.		D: A socket is reserved on the right side of the platform groove	
	E: The height of the fire space is recommended to be greater than 500mm		F: The installation platform is absolutely level and the table top is strong	
	G: The height of the installation platform from the ground is recommended to be greater than 230mm			

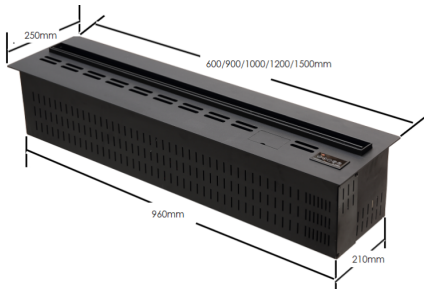

Operation mode:	touch button / wireless remote control
Consumption:	0.6-1.1L / H
Certification:	CE/ROHS/FCC
Voltage frequency:	AC85-265V/50-60HZ



超薄面板
ULTRATHIN



自动注水
WATER FLOODING



超长火焰
OVERLENGTH FLAME



火焰控制
CONTROL



安全保护
SAFEGUARD



支持定制
CUSTOMIZED