

CAUTION

- 1) BE SURE THE ELECTRICITY TO THE WIRES YOU ARE WORKING ON IS SHUT OFF; EITHER THE FUSE IS REMOVED OR THE CIRCUIT BREAKER IS TURNED OFF. TURNING THE POWER OFF USING THE LIGHT SWITCH IS NOT SUFFICIENT TO PREVENT ELECTRICAL SHOCK.
- 2) DO NOT INSTALL OR USE THE LIGHT FIXTURE IF ANY PART IS MISSING OR DAMAGED. CONTACT YOUR DEALER FOR REPLACEMENT OR MISSING PARTS.
- 3) TO PROTECT THE FINISH, DO NOT USE CLEANSERS OR ABRASIVES DURING MAINTENANCE.
- 4) TO AVOID POSSIBLE FIRE OR ELECTRICAL SHOCK, MAKE SURE NO BARE WIRE STRANDS ARE EXPOSED OUTSIDE WIRE CONNECTORS.

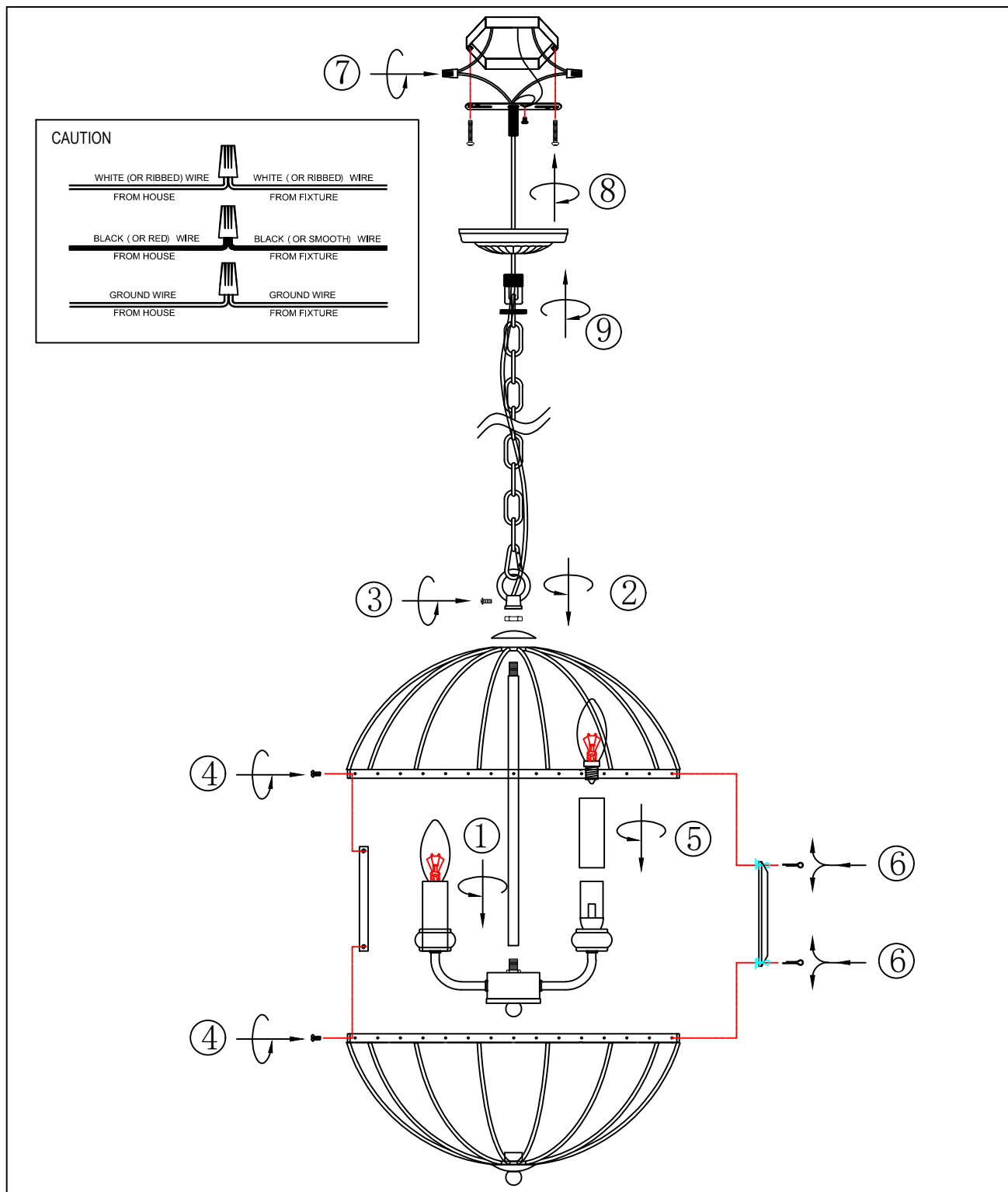

INSTALLATION DIAGRAM



SPECIFICATION

Input Voltage: 110~120V 50/60Hz
 Wattage: E12 Max 40W per socket, bulb not included
 Fixture Size: length 15.75in (40cm) , width 15.75in (40cm) , height 18.11in (46cm)
 Chain Length: 55.12in (140cm) , adjustable

Thank you for shopping with us, please feel free to contact us if you have any issue on product installation or application. Please save this user manual as purchase proof and future reference.

www.mirrea.com

mirrea®

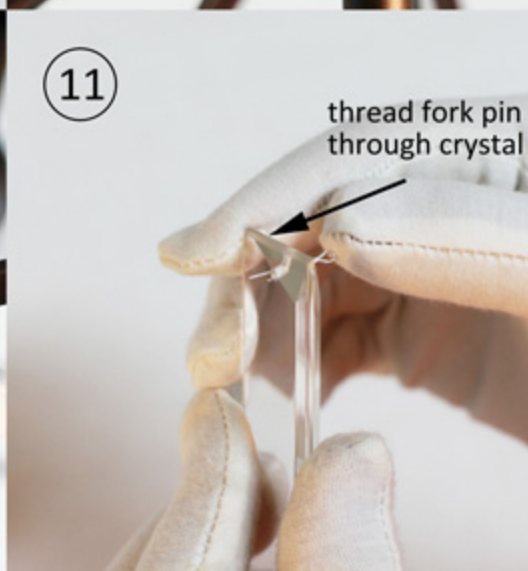
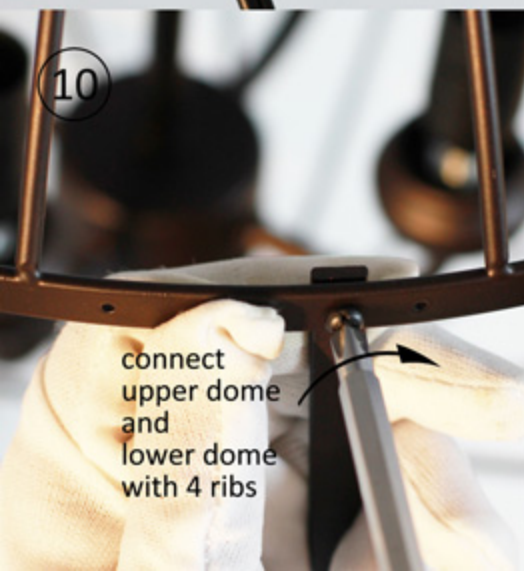
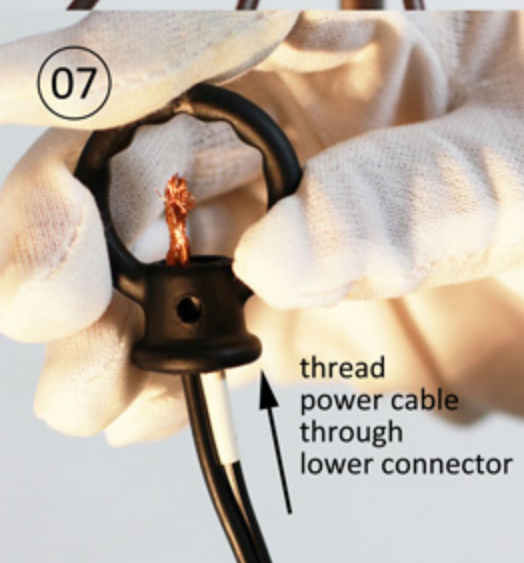
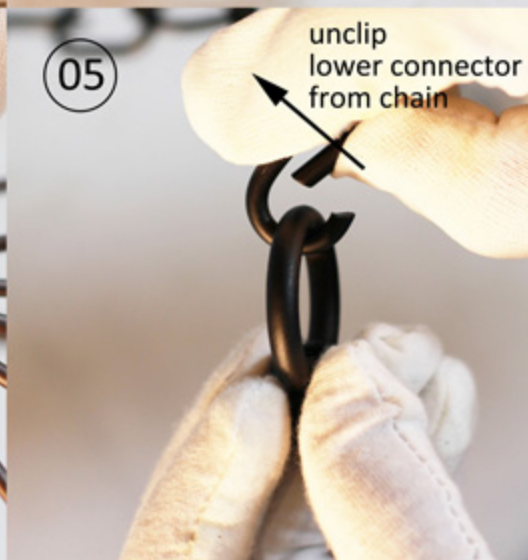
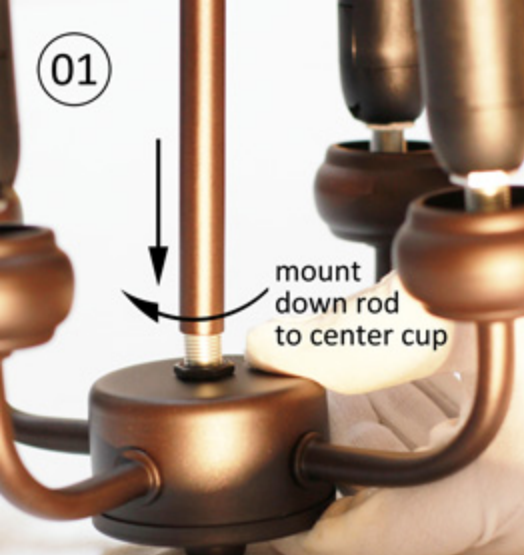



13

bend fork pin
to mount crystal
onto dome rim



14

mount
socket sleeve
and bulb

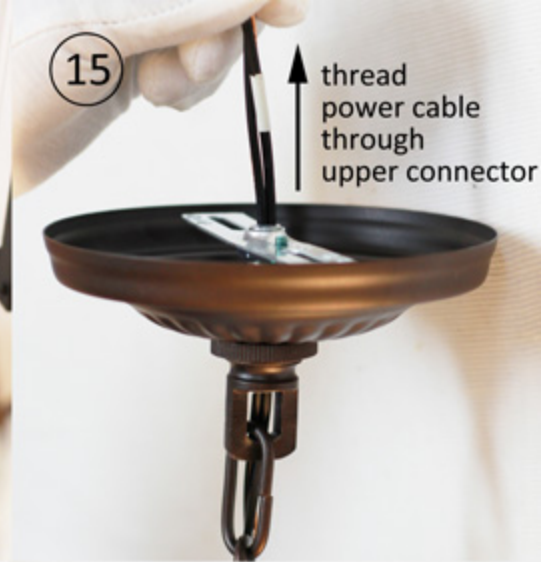

15

thread
power cable
through
upper connector



16

move
nut
down



17

move
canopy
down

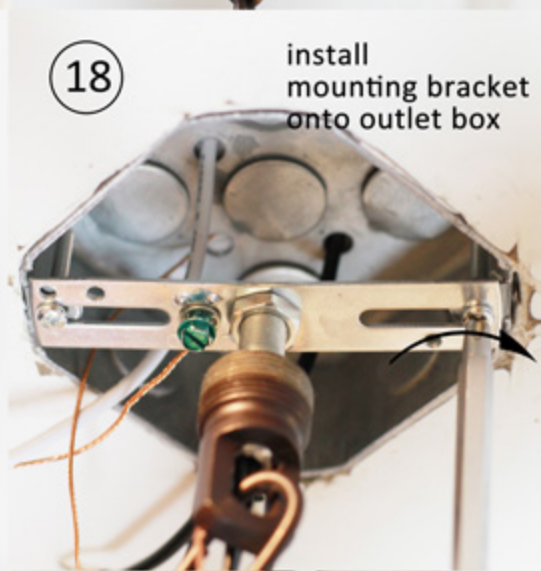

18

install
mounting bracket
onto outlet box

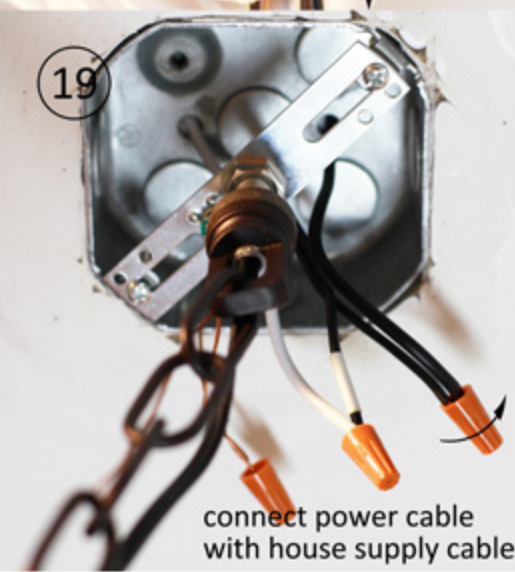

19

connect power cable
with house supply cable



20

move up
canopy and nut,
fasten nut



21

clip
lower connector
with chain